

SURETWIST TIMBER FRAMED WALL TIE for fixing masonry to timber frames.



Applications:

- ▢ Cavity wall tie used in the construction of timber-framed buildings up to four storeys
- ▢ Suitable for use with rigid insulation

Benefits:

- ▢ One-piece stainless steel tie
- ▢ High performance tie
- ▢ Quick, easy, hammer-driven installation
- ▢ Fixed through insulation with no adverse effect to thermal properties
- ▢ Flexible to meet natural building movement
- ▢ Stress-free to avoid timber splitting
- ▢ Multiple drip, due to helical design
- ▢ Supplied with optional insulation support
- ▢ Tested to EN 846-5:2012 giving a higher performance than DD140 type 6

SURETWIST QUANTITIES/m²

Masonry-to-Timber Tie Types to BS 5268-6.1: 1996	EN 845-1:2013
4.4 ties/m ² 3-4 ties/m ² at unbonded edges	Suitable for use up to 4 storeys. 15m flat sites within towns and cities where the basic wind speed does not exceed 25m/s and altitude is not more than 150m above sea level

SURETWIST TIE SELECTION CHART

CAVITY mm	TIES COMPLYING TO EN 845-1:2013	Recommended lengths - mm
50	170mm	195mm
75	195mm	220mm
100	220mm	245mm
125	245mm	270mm
150	270mm	300mm
165	295mm	320mm

The recommended length of tie should be used in site conditions. The tested lengths purely relates to test conditions, which shows a minimum length when tested.

Range: SureTwist Plus

4.5mm x 170, 195, 220, 245, 270 and 295mm. Pack Qty 100

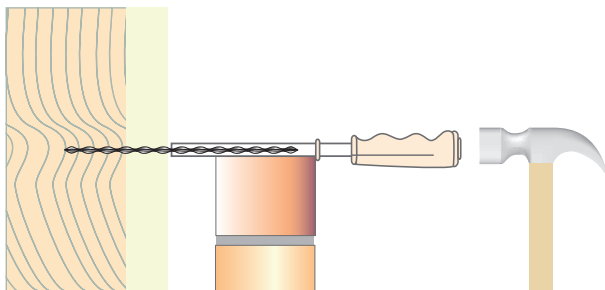

1. Position the tie into the hand held fixing tool as shown above. Drive directly into timber stud through insulation.

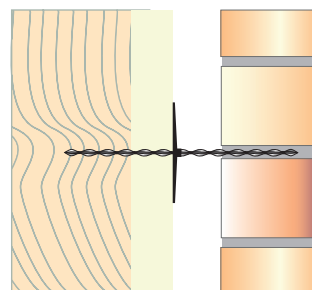

2. Place insulation support over tie, and embed the outer end into the outer leaf mortar.



Insulation Supports available upon request.

LUCID EON
An Independent Testing Centre
Report number: 15639



CONSTRUCTION PRODUCTS SOLUTIONS INTERNATIONAL LTD.

Unit 3, Haslemere Industrial Estate, Pig Lane, Bishop's Stortford, Hertfordshire. CM23 3HG. United Kingdom.
Tel: +44(0)1279 505 514 - Fax: +44(0)1279 755190 - e mail: info@surecps-group.com - www.surecps-group.com
Company Reg. 6969591 VAT Reg. GB 824 4246 40



Please always wear the appropriate safety and protective clothing when installing fixing and anchor products. Always observe the necessary Health & Safety guidelines.

© All text copyright. Above information is given as guidance only and should always be verified by a suitable engineer.

The above information is given in good faith, and may be subject to alteration at any time without prior notification.