



CPSI LATERAL RESTRAINT TIES

The CPSI Heavy Weight Lateral Restraint Wall Tie for restraining bulging walls.



Applications:

- ▢ The CPSI HW lateral restraint wall tie is for restraining bulging walls. Tying the wall to two or more timber side joists or studs using these 10mm diameter stainless steel ties
- ▢ The CPSI HW lateral restraint wall ties are fitted from outside the property with a minimum of disturbance in most cases just lift a few floorboards to determine the position of the joists and to ensure hidden wires or pipes are avoided during the installation
- ▢ Each restraint tie has a drill-like leading end for cutting into softwood. Using a SDS drill, simply wind the lateral restraint ties (using the installation tool) into the timbers and resin fix the masonry end

SDS setting tool for driving Lateral Restraint Ties into side of parallel floor joists, countersinking the remedial tie beneath the surface of the wall. Screws onto tie bar and fits into SDS drill. Driven into joists with hammer action disengaged.

Benefits:

- ▢ Quick and Easy installation
- ▢ Economical to use
- ▢ 304 austenitic stainless steel
- ▢ Minimal disruption
- ▢ Prevents timber splitting
- ▢ Allows for normal movement
- ▢ High performance
- ▢ Easy selection
- ▢ Smart finished appearance (No wall plates)

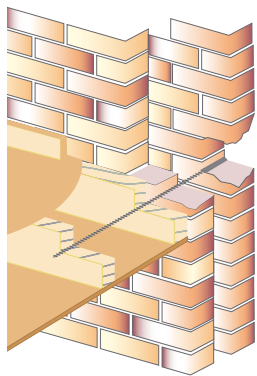

For fixing the CPSI HW Lateral Restraint Ties you need: – A SDS hammer drill, a 14mm x 400mm SDS drill bit for drilling the wall, an installation tool for driving the restraint ties into the timbers, and SureBond Polyester resin and resin applicator gun to bond the ties to the masonry wall.

Axial Spacing:

Horizontal centres 600mm or as recommended by a structural engineer.

Range: Heavy Weight Lateral Restraint Tie

HW 10 x 1000 – HW 10 x 1500

Installation:

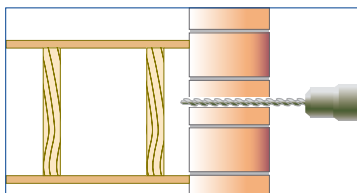

1. Mark the position of the joist centre on the external wall and drill a clearance hole (normally 14mm) through the wall.

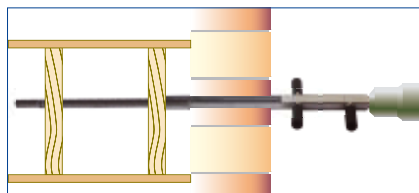

2. Insert restraint tie into the inst. tool fitted to an SDS rotary hammer drill and drive it (off hammer) through first and second joists. Remove key.

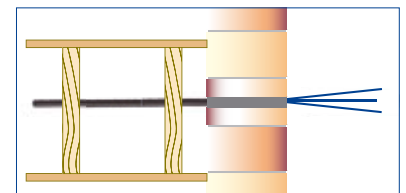

3. Inject SureBond polyester resin to fill hole, allow to set and make good with SureBond colour-pointing mortar.

CONSTRUCTION PRODUCTS SOLUTIONS INTERNATIONAL LTD.

Unit 3, Haslemere Industrial Estate, Pig Lane, Bishop's Stortford, Hertfordshire. CM23 3HG. United Kingdom.
Tel: +44(0)1279 505 514 - Fax: +44(0)1279 755190 - e mail: info@surecps-group.com - www.surecps-group.com
Company Reg. 6969591 VAT Reg. GB 824 4246 40



CPSI SE LATERAL RESTRAINT TIES

The CPSI Lateral Restraint Tie – for restraining bulging walls.



Range: SureTwist Extra

- TC8mm x 195mm – TC9mm x 195mm
- TC8mm x 220mm – TC9mm x 220mm
- TC8mm x 245mm – TC9mm x 245mm
- TC8mm x 270mm – TC9mm x 270mm
- TC8mm x 300mm – TC9mm x 300mm

For fixing the CPSI Lateral Restraint Ties you need: A SDS hammer drill, a 12mm x 300mm SDS drill bit for drilling the wall – A SDS support tool for driving the restraint into timbers and SureBond Polyester resin and resin applicator gun to bond the ties to the masonry wall.

Axial spacing:

Horizontal centres 600mm or as recommended by a structural engineer.

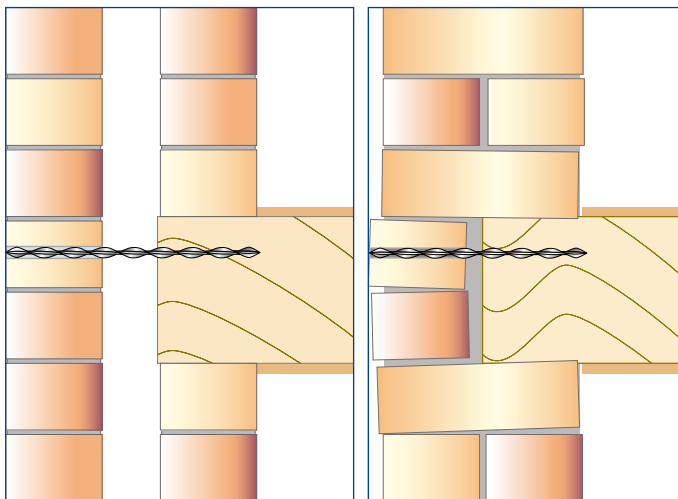

Applications:

- ▢ The CPSI lateral restraint tie is for restraining bulging walls. Tying the wall to the end of the joist using TC8mm and TC9mm SureTwist helical stainless steel ties
- ▢ The CPSI lateral restraint wall ties are fitted from outside the property with a minimum of disturbance

Benefits:

- ▢ Quick and Easy installation
- ▢ Economical to use
- ▢ 304 austenitic stainless steel
- ▢ Minimal disruption
- ▢ Prevents timber splitting
- ▢ Allows for normal movement
- ▢ High performance
- ▢ Easy selection
- ▢ Smart finished appearance (No wall plates)
- ▢ Suitable for both cavity and solid walls

Installation:

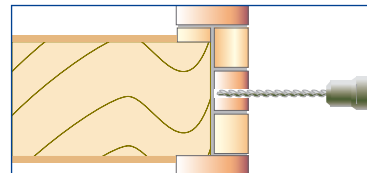

1. Mark the position of the joist centre on the external wall and drill a clearance hole (normally 12mm) through the wall.

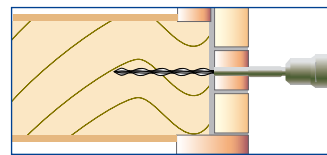

2. Insert tie into support tool fitted to an SDS rotary hammer drill. Drive (on hammer) into the joist end to a depth of min. 75mm.

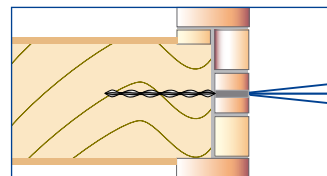

3. Inject SureBond polyester resin to fill the hole, allow to set and make good with SureBond colour-pointing mortar.

CONSTRUCTION PRODUCTS SOLUTIONS INTERNATIONAL LTD.



Unit 3, Haslemere Industrial Estate, Pig Lane, Bishop's Stortford, Hertfordshire. CM23 3HG. United Kingdom.
Tel: +44(0)1279 505 514 - Fax: +44(0)1279 755190 - e mail: info@surecps-group.com - www.surecps-group.com
Company Reg. 6969591 VAT Reg. GB 824 4246 40



Please always wear the appropriate safety and protective clothing when installing fixing and anchor products. Always observe the necessary Health & Safety guidelines.

© All text copyright. Above information is given as guidance only and should always be verified by a suitable engineer.

The above information is given in good faith, and may be subject to alteration at any time without prior notification.